

# Watering Actuator

HmIP-WSM



## Table of contents

1 Package contents.....	3
2 Information about this manual.....	3
3 Hazard information.....	3
4 Function and device overview.....	5
5 General system information.....	5
6 Start-up.....	5
6.1 Pairing with a control centre.....	6
6.2 Installation.....	6
6.3 Fitting the valve adapter (3/4-inch male thread to 1-inch female thread).....	7
7 Operation.....	8
8 Restoring factory settings.....	8
9 Maintenance and cleaning.....	9
10 General information about wireless operation.....	9
11 Disposal.....	10
12 Technical specifications.....	11

## 1 Package contents

- 1x Watering Actuator
- 1x Valve adapter (1" to 3/4" reducer)
- 2x 1.5 V LR6/Mignon/AA batteries
- 1x Operating manual

## 2 Information about this manual

Read this manual carefully before starting to use the device. Keep the manual so you can refer to it at a later date if you need to. If you hand over the device to other persons for use, please hand over this manual as well.

### Symbols used:

 This indicates a hazard.

 This section contains important additional information!

## 3 Hazard information

 We assume no liability for damage to property or personal injury caused by improper use or the failure to observe the hazard warnings. In such cases, all warranty claims are void. We accept no liability for any consequential damage.

 There is a risk of explosion if the batteries are not replaced correctly. Doing so will present a risk of explosion.  
Only replace batteries with the same or an equivalent type. Never charge batteries. Do not throw the batteries into a fire. Do not expose batteries to excessive heat. Do not short-circuit batteries.

 Risk of injury from leaking or damaged batteries.  
These can cause chemical burns if they come into contact with skin. Wear suitable protective gloves.





 The device does not contain any parts that can be serviced by the user.  
Do not open the device. If you have any doubts, have the device checked by an expert.

 Do not use the device if there are signs of damage to the housing, control elements or connecting sockets, for example, or if it demonstrates a malfunction.  
If you have any doubts, have the device checked by an expert.

 For safety and licensing reasons (CE), unauthorized conversions to and/or modification of the device is not permitted.

 The device is not a toy; Plastic films/bags, pieces of polystyrene, etc. can be dangerous in the hands of a child.  
do not allow children to play with it. Do not leave packaging material lying around.

 Using the device for any purpose other than that described in this operating manual does not fall within the scope of intended use and will invalidate any warranty or liability. This also applies to any conversion or modification work. The device is intended for private use only.

-  Do not operate the Water Actuator in drinking water systems. The appliance is only suitable for use in garden watering systems.
-  Only operate the Water Actuator with untreated, clear fresh water at a maximum temperature of 50°C.
-  Only connect the device to a professionally installed external outlet valve with hose fitting / external valve (tap). Do not pull on the connected hose.
-  The Watering Actuator is not frost-proof and must be dismantled and stored in a frost-proof location before the start of frosty weather. The device stops operating below 5°C and closes automatically.
-  If the union nut jams or is difficult to turn when screwing on by hand, do not use tools to tighten it – this indicates a fitting problem. Check that the threads are correctly engaged and not crossed.

## 4 Function and device overview

The Homematic IP Watering Actuator with measuring function allows simple and efficient control of garden watering via the app. After inserting the batteries, the device is immediately ready for use and enables garden watering to be switched on and off via individual time schedules or directly at the device.

The device can be quickly and easily installed on a tap. The integrated measuring sensor measures the flow rate and the amount of water and transmits this data regularly to the system. This means that you always have an eye on your water consumption and watering can be precisely controlled.

With protection class IP44, the Watering Actuator is ideal for outdoor use and ensures reliable operation, regardless of the weather conditions.

### Device overview

- A) Union nut / water inlet (1" female thread)
- B) System button (device LED)
- C) Water outlet (3/4" male thread)
- D) Filter gasket
- E) Battery compartment
- F) Battery slide

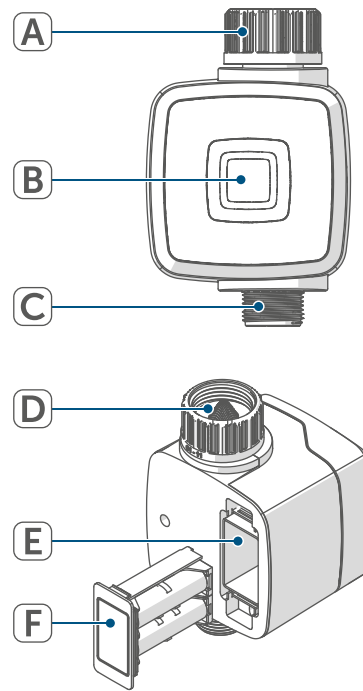

Figure 2

## 5 General system information

This device is part of the Homematic IP Smart Home System and communicates via the Homematic IP Wireless protocol. All devices in the system can be conveniently and individually configured via the Homematic IP App. Operation requires connection to a Homematic IP Access Point or a Central Control Unit.. Further information about the system and how to combine it with other Homematic IP devices is to be found in the Homematic IP *User guide*..

All technical documents and updates are to be found at [www.homematic-ip.com](http://www.homematic-ip.com).

## 6 Start-up

- i** We recommend that you first pair the device if you want to operate several devices at the same time or if the installation location of the device is difficult to access.

## 6.1 Pairing with a control centre

- i** Read this entire section before starting the pairing procedure.
- i** Set up your Central Control Unit via the Homematic IP Homematic IP App so that you can use devices in the system. Homematic IP Detailed information on this is to be found in the operating manual for the Central Control Unit..

Proceed as follows to pair the device with your control centre:

- Open the Homematic IP App.
- Tap on **...More** in the homescreen.
- Tap on **Pair device**.
- Remove the insulation strip from the battery compartment.
- The pairing mode is active for 3 minutes.
- i** You can manually start the pairing mode for another 3 minutes by pressing the system button shortly.

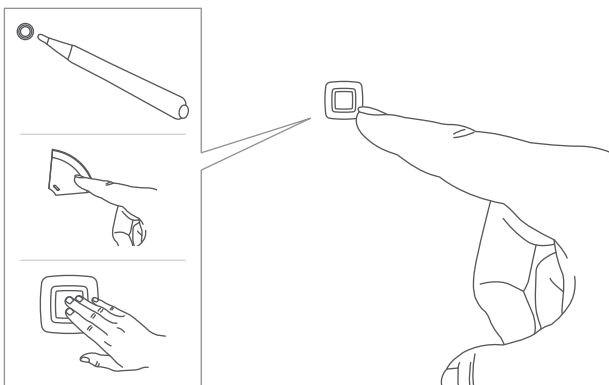

Figure 3

- i** The type of system button depends on your device. Further information is to be found in the privacy statement.
- Your device will automatically appear in the Homematic IP App.
- Enter the last four digits of the device number (SGTIN) in your app or scan the QR code. The device number can be found on the sticker supplied or attached to the device.
- Wait until pairing is completed.
- If pairing was successful, the device LED lights up green.
- The device is now ready for use.

- i** If the device LED lights up red, try again (*Flash codes and displays*).
- Finally, follow the instructions in the Homematic IP App.

## 6.2 Installation

- i** Please read this entire section before starting the installation.

The watering sensor can be installed without additional tools.

- Turn off the tap completely.
- Remove any existing adapters or connections.
- Check that the thread is clean and undamaged.
- Open the battery slide on the back of the device. To do this, pull firmly on the top and bottom of the battery slide.

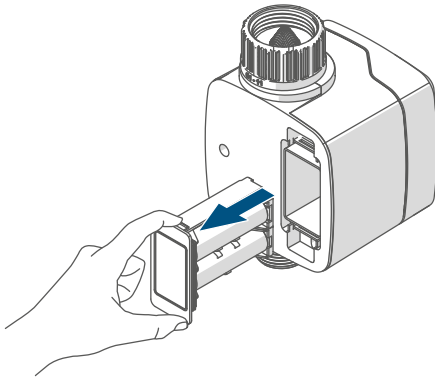

Figure 4

- Insert two 1.5 V LR6/Mignon/AA batteries with the correct polarity in accordance with the markings.

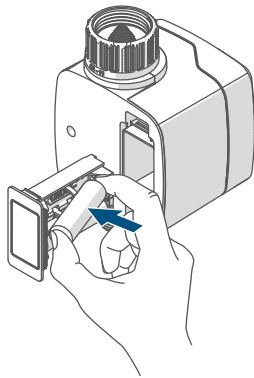

Figure 5

- Close the battery slide.

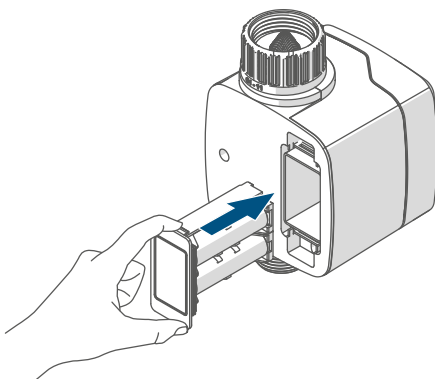

Figure 6

**i** Once the batteries have been inserted, the device will perform a self-test for approx. 2 seconds. Afterwards, initialisation is carried out. The LED test display will indicate that initialisation is complete by lighting up orange and green.

- Check that the filter gasket is inserted correctly or insert it if necessary.
- Carefully screw the Watering Actuator onto the thread of the tap by hand. Ensure a firm but not over-tightened fit.

**i** A valve adapter is required for water valves with a 3/4-inch external thread [see \(Fitting the valve adapter \(3/4-inch male thread to 1-inch female thread\)\)](#), page 7.

- Turn the tap on slowly.
- Make sure that there are no leaks in the connections after installation.
- Start a test watering via the app or on the device.
- Make sure that the measurement data is displayed correctly.

The Watering Actuator is now fully installed and ready for use.

### 6.3 Fitting the valve adapter (3/4-inch male thread to 1-inch female thread)

If you have a water valve with a 3/4-inch external thread, you must first fit the enclosed valve adapter for the 1-inch internal thread of the Watering Actuator to be able to mount the device. To do this, proceed as follows:



- Ensure that the threads on the Watering Actuator and the tap are free of dirt and residues.
- Screw the enclosed valve adapter onto the thread of the tap by hand.

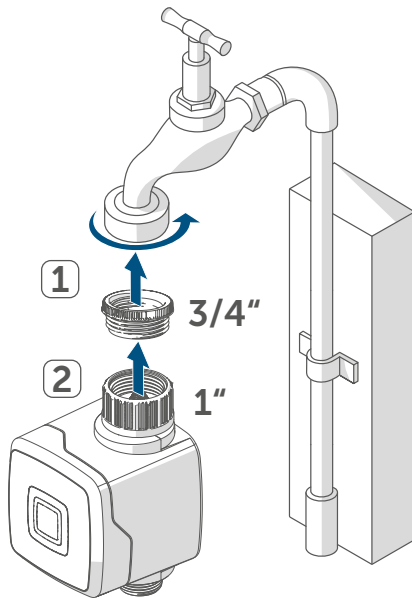

Figure 7

- Then attach the Watering Actuator as described in section [Installation](#) onto the valve.

## 7 Operation

After commissioning, simple operating functions are available directly on the device.

**Button press:** You can open or close the valve by pressing a button directly on the appliance.

**i** Once the batteries have been inserted, the device will perform a self-test for approx. 2 seconds. Afterwards, initialisation is carried out. The LED test display will indicate that initialisation is complete by lighting up orange and green.

If there is a risk of frost ( $< 5^{\circ}\text{C}$ ), the device automatically closes the water valve. The safety switch-off is displayed with an error message using the app. The temperature must rise above  $8^{\circ}\text{C}$  before the device can be used again. The Watering Actuator does not switch on automatically after the safety switch-off. As the device is not frost-proof, it should be dismantled and stored in a frost-proof location if there is a risk of frost.

## 8 Restoring factory settings

**i** The factory settings of the device can be restored. If the device is paired with a Central Control Unit, the configurations are automatically restored. If the device is not paired with a Central Control Unit, all the settings are lost.

Proceed as follows to restore the factory settings of the device:

- Remove one battery from the battery compartment.
- Please wait a minute.
- Press and hold the system button for 4 seconds ([Fig. 2](#)) and insert the battery at the same time. Pay attention to the correct polarity marking
- The device LED starts flashing orange quickly.
- Release the system button .
- Press and hold the System button for 4 s.
- The device LED lights up green.
- Release the system button to finish restoring the factory settings.

The device will perform a restart.



**i** If the device LED lights up red, try again (*Flash codes and displays*).

## 9 Maintenance and cleaning

**i** The device is maintenance-free for you, except for any necessary battery changes, , Leave any maintenance or repair to a specialist.

Clean the device using a soft, clean, dry and lint-free cloth. The cloth can be slightly dampened with lukewarm water to remove more stubborn marks. Do not use any detergents containing solvents for cleaning purposes. They could corrode the plastic housing and label.

The filter gasket in the union nut at the water inlet should be checked regularly and cleaned if necessary.

- Unscrew the union nut of the Watering Actuator from the thread of the tap.
- Remove the valve adapter if necessary.
- Remove the filter gasket from the union nut and clean it.
- Refit the Watering Actuator.

## 10 General information about wireless operation

Radio transmission is performed on a non-exclusive transmission path, which means that there is a possibility of interference occurring. Interference can also be caused by switching operations, electrical motors or defective electrical devices.

**i** The range inside buildings can differ greatly from that in open air. Besides the transmitting power and the reception characteristics of the receiver, environmental factors such as humidity in the vicinity play an important role, as do on-site structural/screening conditions.

### Declaration of conformity

eQ-3 AG, Maiburger Str. 29, 26789 Leer, Germany, hereby declares that the wireless system type Homematic IP HmIP-WSM complies with Directive 2014/53/EU. The full text of the EU declaration of conformity can be found at: [www.homematic-ip.com](http://www.homematic-ip.com)

## 11 Disposal



This symbol means that the device and the batteries or accumulators must not be disposed of as household waste, general waste, or in a yellow bin or yellow sack. For the protection of health and the environment, you must take the product, all electronic parts included in the package contents, and the batteries to a municipal collection point for waste electrical and electronic equipment to ensure correct disposal of the same. Distributors of electrical and electronic equipment or batteries must also take back waste equipment or used batteries free of charge. By disposing of them separately, you are making a valuable contribution to the reuse, recycling and other methods of recovery of used devices and used batteries. You must separate any used single-use and rechargeable batteries found in used electrical and electronic devices from the used device if they are not enclosed by the used device before handing it over to a collection point and dispose of them separately at the local collection points. Please also remember that you, the end user, are responsible for deleting personal data on any waste electrical and electronic equipment before disposing of it.



If you have any technical questions about the appliance, please contact your specialist dealer.



The CE mark is a free trademark that is intended exclusively for the authorities and does not imply any assurance or guarantee of properties.

## 12 Technical specifications

Short description	HmIP-WSM
Supply voltage	2x 1.5 V LR6/Mignon/AA
Battery life	1 year (typ.)
Degree of protection	IP44
Ambient temperature	5 - 55°C
Weight (incl. batteries)	365 g
Dimensions (W x H x D)	137 x 82 x 88 mm
Current consumption	1000 mA max. / 50 µA typical
Construction of the regulation and control device: (RS)	Free-standing electronic regulation and control device
Water inlet connecting thread	33.3 mm (G1")
Water outlet connecting thread	26.5 mm (G3/4")
Flow rate sensor	2 - 45 l/min
Maximum working pressure	0.9 MPa / 9 bar
Mode of operation	Directly controlled
Actuator	Magnetic coil
Maximum water temperature	50°C
Degree of pollution	2
Typical Open area RF range	440 m
Radio frequency band	868.0-868.6 MHz / 869.4-869.65 MHz
Duty cycle	< 1% per h / < 10% per h
Receiver category	SRD category 2
Maximum radiated power	10 dBm

**Subject to modifications.**

# Free download of the Homematic IP app!



Bevollmächtigter des Herstellers:  
Manufacturer's authorised representative:

**eQ-3**

eQ-3 AG  
Maiburger Straße 29  
26789 Leer / GERMANY  
[www.eQ-3.de](http://www.eQ-3.de)